

2025 TRACK AND FIELD IMPROVEMENTS



Christian Academy
OF INDIANA



Christian Academy School System

TowerPinkster

ARCHITECTURE • ENGINEERING • INTERIORS

DRAWING INDEX

G001	COVER SHEET	
C000	SURVEY	J. BRINKWORTH & ASSOCIATES
C001	EXISTING SITE LAYOUT PLAN	
CD101	SITE DEMOLITION PLAN	
C101	SITE DEVELOPMENT PLAN	
C102	SITE DIMENSION PLAN	
C201	STORM DRAINAGE PLAN	
C301	TRACK AND FIELD DETAILS	



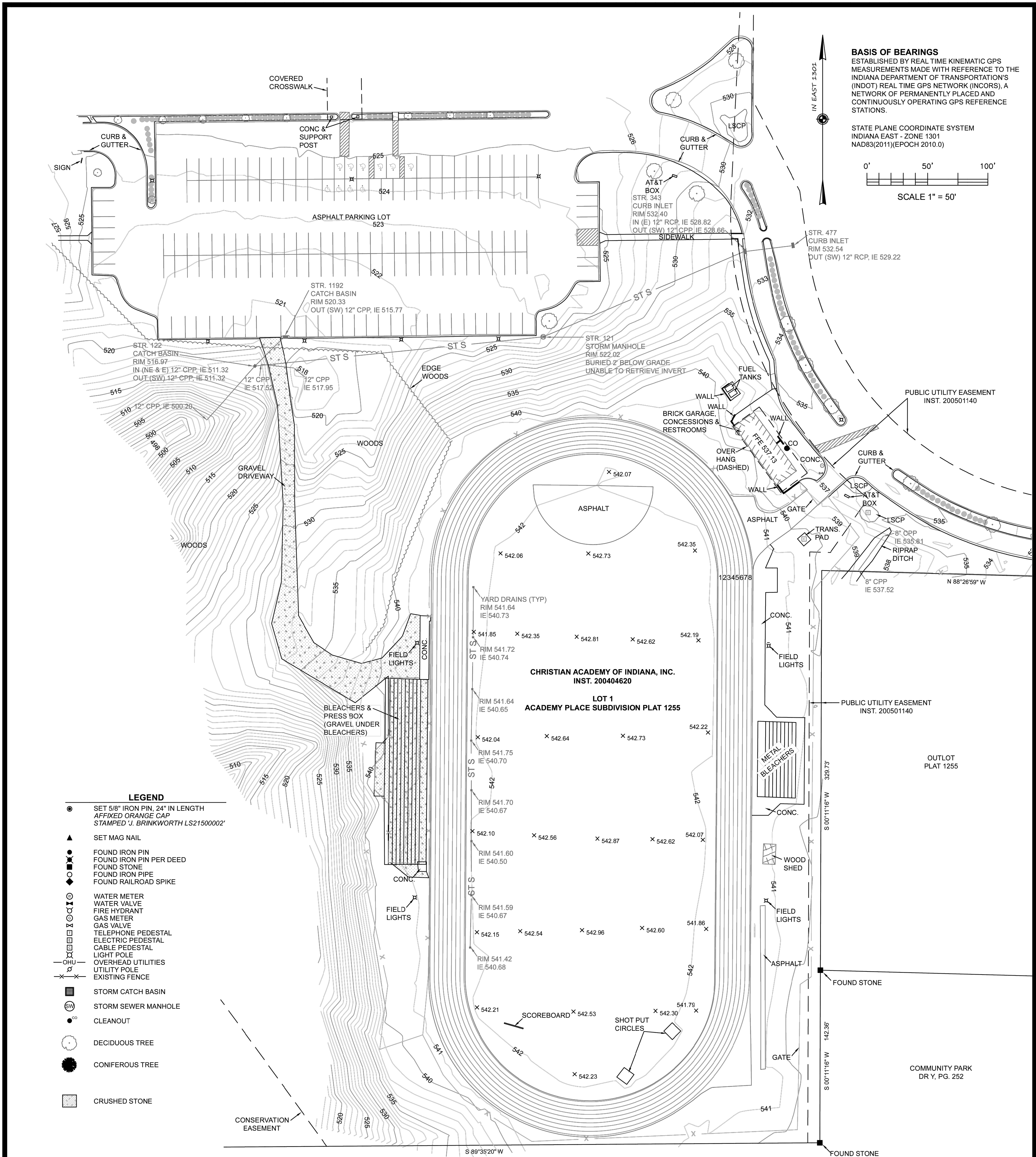

LEGEND

- SET 5/8" IRON PIN, 24" IN LENGTH, AFFIXED ORANGE CAP, STAMPED "J. BRINKWORTH LS215000002"
- SET MAG NAIL
- FOUND IRON PIN
- FOUND IRON PIN PER DEED
- FOUND STONE
- FOUND IRON PIPE
- FOUND RAILROAD SPIKE
- WATER METER
- WATER VALVE
- FIRE HYDRANT
- GAS METER
- GAS VALVE
- TELEPHONE PEDESTAL
- ELECTRIC PEDESTAL
- CABLE PEDESTAL
- LIGHT POLE
- OVERHEAD UTILITIES
- UTILITY POLE
- EXISTING FENCE
- STORM CATCH BASIN
- STORM SEWER MANHOLE
- CLEANOUT
- DECIDUOUS TREE
- CONIFEROUS TREE
- CRUSHED STONE

THIS SURVEY WAS PERFORMED WITHOUT THE BENEFIT OF A TITLE EXAMINATION AND IS SUBJECT TO ALL FACTS SAID EXAM MAY REVEAL.

PROJECT: 25-851
CHRISTIAN ACADEMY

SCALE:
1" = 50'

SHEET
1 OF 1

J. BRINKWORTH & ASSOCIATES
SURVEYORS | ENGINEERS | PLANNERS

5150 CHARLESTOWN ROAD, SUITE 3A
NEW ALBANY, INDIANA 47150
812-944-6731

TOPOGRAPHIC SURVEY
ACADEMY PLACE SUBDIVISION
PART OF LOT 1, PLAT 1255
FLOYD COUNTY, INDIANA

ISSUED FOR	DATE
1	Issue Date
2	Issue Date
3	Issue Date
4	Issue Date
5	Issue Date
6	Issue Date
7	Issue Date
8	Issue Date

PROJECT TITLE
CHRISTIAN ACADEMY OF INDIANA
2025 TRACK AND FIELD IMPROVEMENTS

1000 ACADEMY DRIVE
NEW ALBANY, INDIANA 47150

OWNER
CHRISTIAN ACADEMY
SCHOOL SYSTEM

SHEET TITLE
SURVEY: J. BRINKWORTH & ASSOCIATES

SHEET NUMBER
C000
24-239,001

DATE
06/08/2025

DRAWN BY
Checked By

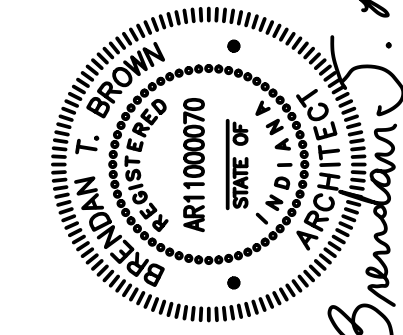

ISSUED FOR	DATE
1	Issue Date
2	Issue Date
3	Issue Date
4	Issue Date
5	Issue Date
6	Issue Date
7	Issue Date
8	Issue Date

PROJECT TITLE
CHRISTIAN ACADEMY OF INDIANA
2025 TRACK AND FIELD IMPROVEMENTS

OWNER
CHRISTIAN ACADEMY
SCHOOL SYSTEM

1000 ACADEMY DRIVE
NEW ALBANY, INDIANA 47150



OWNER
CHRISTIAN ACADEMY
SCHOOL SYSTEM

Drawn	CJB
Checked By	BB

DATE
06/08/2025

SHEET NUMBER
CD101
24-239-001

SHEET TITLE
Site Demolition Plan

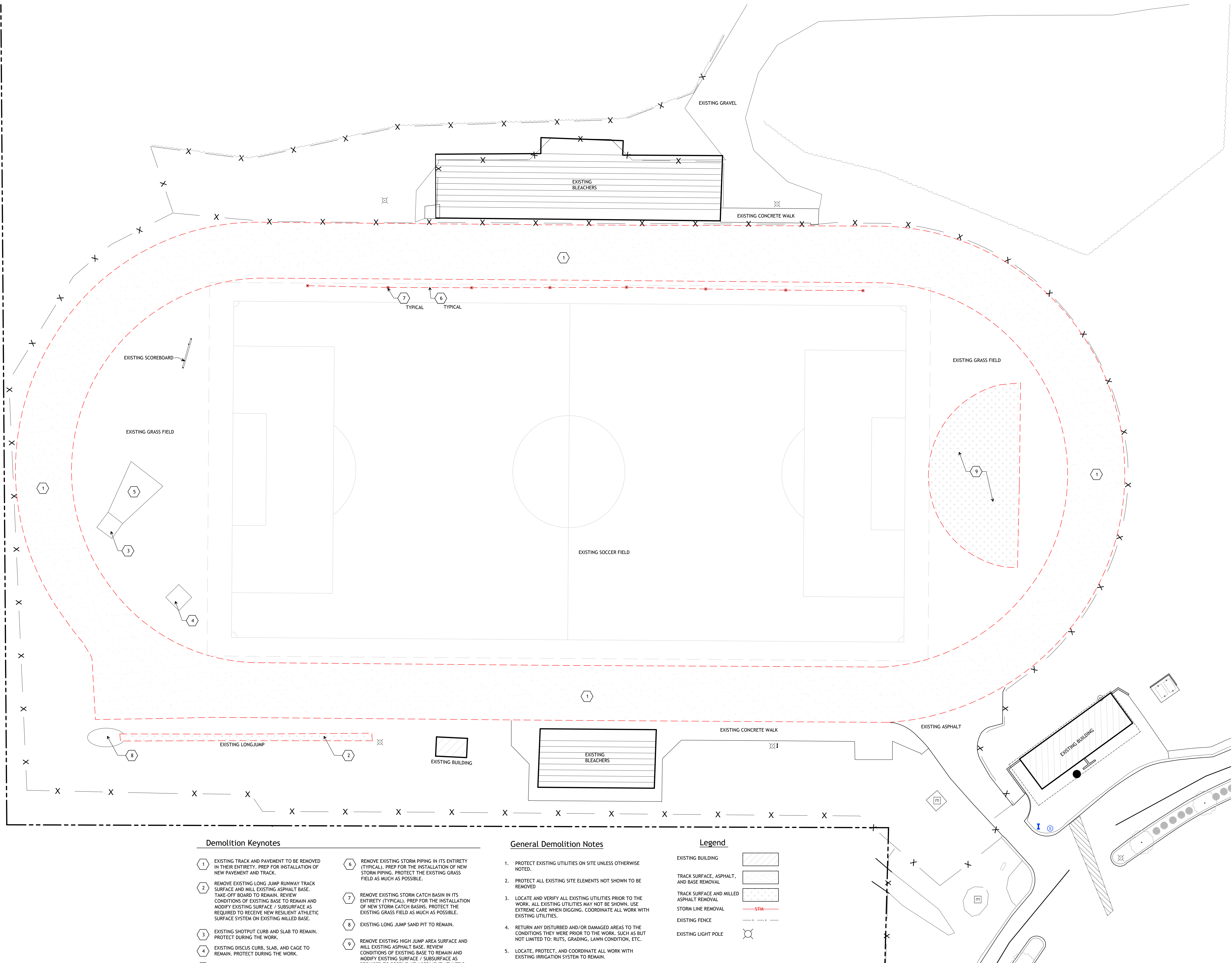

NOTE: THIS DRAWING IS INTENDED TO BE PLOTTED IN COLOR. IF THIS NOTE DOES NOT APPEAR IN COLOR, IT IS PLOTTED INCORRECTLY. DISCARD AND OBTAIN AN ACCURATE DRAWING

Notice
The Architect/Engineer does not define the scope of individual trades, subcontractors, material suppliers, or vendors. Any sheet numbering system used which identifies disciplines is solely for the Architect/Engineer's convenience, and is not intended to define a subcontractor's scope of work. Information regarding individual trades, subcontractors, material suppliers, and vendors may be detailed, described and indicated at different locations throughout these documents. No consideration will be given to requests for change orders for failure to obtain and review the complete set of drawings and specifications when preparing bids, prices, and quotations.



ISSUED FOR	DATE
Issue Date	Issue Date
Issue Date	Issue Date
Issue Date	Issue Date
Issue Date	Issue Date
Issue Date	Issue Date
Issue Date	Issue Date
Issue Date	Issue Date
Issue Date	Issue Date

PROJECT TITLE
CHRISTIAN ACADEMY OF INDIANA
2025 TRACK AND FIELD IMPROVEMENTS
1000 ACADEMY DRIVE
NEW ALBANY, INDIANA 47150



OWNER
CHRISTIAN ACADEMY
SCHOOL SYSTEM

Drawn	OS & CB
Checked By	BB

DATE
06/08/2025

SHEET NUMBER
C101
24-239-001

SHEET TITLE
Site Development Plan

...

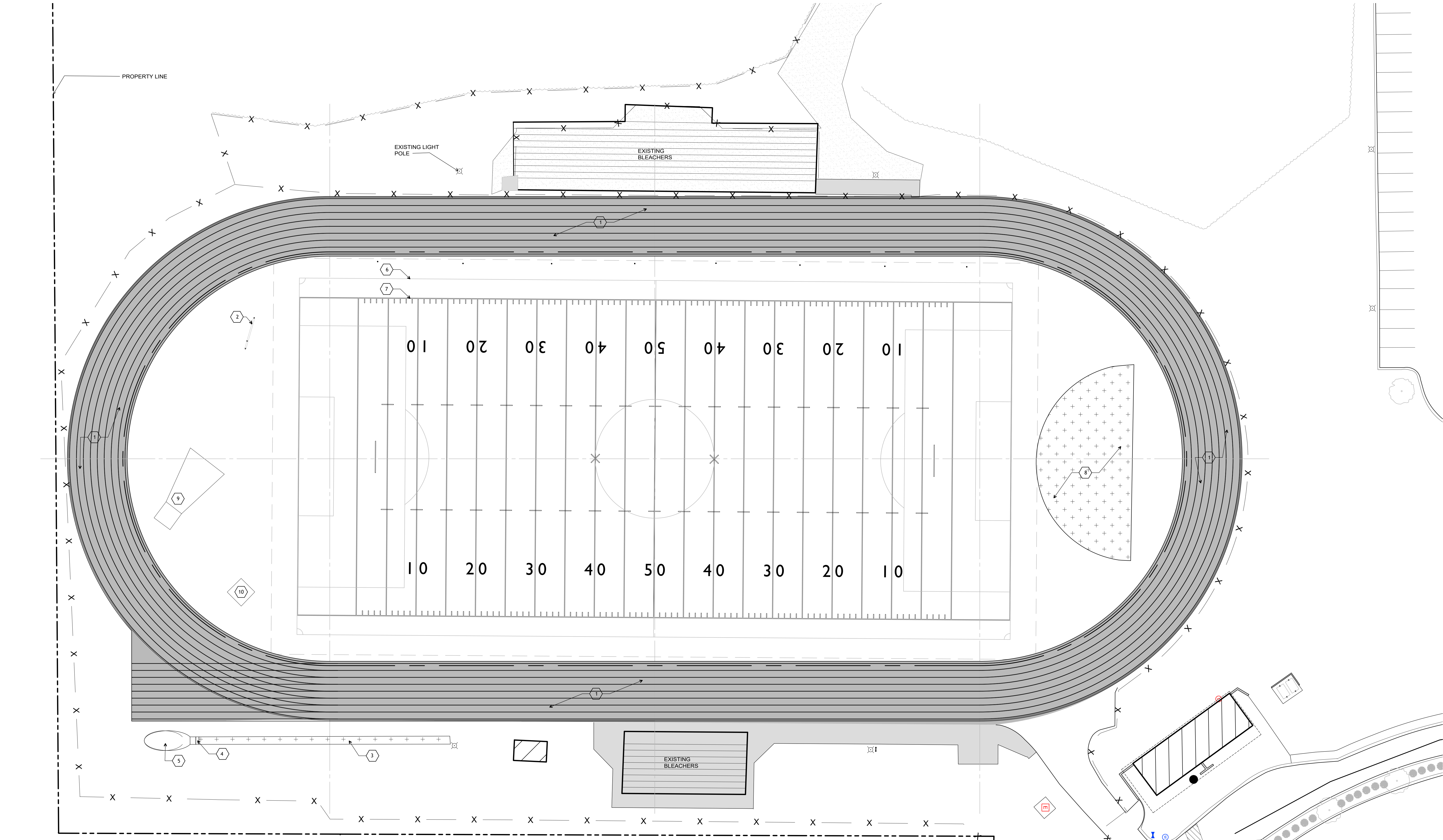

Site Development Keynotes

- NEW 8-LANE TRACK (RESILIENT ATHLETIC SURFACE SYSTEM), LOCATED IN APPROXIMATELY THE SAME LOCATION AS THE EXISTING TRACK TO BE REMOVED. SLOPE OF NEW TRACK (1% MAXIMUM) SHALL DRAIN TO GRASS AREA INSIDE TRACK. SEE C201 FOR NEW STORM DRAINAGE. SEE DETAILS 1/C301 THROUGH 6/C301.
- EXISTING SCOREBOARD TO REMAIN. COORDINATE NEW WORK WITH EXISTING UTILITIES.
- LONG JUMP RUNWAY AREA. RE-SURFACE WITH RESILIENT ATHLETIC SURFACE SYSTEM ON EXISTING MILLED BASE. REVIEW CONDITIONS OF EXISTING BASE TO REMAIN AND MODIFY EXISTING SURFACE / SUBSURFACE AS REQUIRED TO RECEIVE NEW SYSTEM.
- EXISTING LONG JUMP TAKE OFF BOARD TO REMAIN.
- EXISTING LONG JUMP PIT TO REMAIN.
- EXISTING GRASS SOCCER FIELD AND STRIPING. ACTUAL SIZE AND LOCATION OF SOCCER FIELD MAY VARY.
- POSSIBLE LAYOUT OF FUTURE FOOTBALL FIELD FOR REFERENCE ONLY. FOOTBALL FIELD DOES NOT EXIST AND IS NOT PART OF THIS PROJECT.
- HIGH JUMP AREA. RE-SURFACE WITH RESILIENT ATHLETIC SURFACE SYSTEM ON EXISTING MILLED BASE. REVIEW CONDITIONS OF EXISTING BASE TO REMAIN AND MODIFY EXISTING SURFACE / SUBSURFACE AS REQUIRED TO RECEIVE NEW SYSTEM.
- EXISTING SHOTPUT CIRCLE AND SAND AREA TO REMAIN.
- EXISTING DISCUS CIRCLE AND CAGE AREA TO REMAIN.

General Notes

- ALL EFFORTS SHOULD BE TAKEN TO NOT DISTURB AREAS BEYOND THE LIMITS OF CONSTRUCTION. FENCING SHOULD BE USED TO SECURE THE CONSTRUCTION SITE SO NO DAMAGE IS DONE TO EXISTING SITE FEATURES IN PLACE.
- EVERY EFFORT SHALL BE MADE TO PROTECT ELEMENTS REMAINING IN PLACE DURING CONSTRUCTION ACTIVITY. ANY DAMAGE THAT OCCURS DURING CONSTRUCTION WILL BE REPAIRED TO PRE-CONSTRUCTION CONDITION, AT THE COST OF THE CONTRACTOR.
- SEE C102 FOR DIMENSION PLAN.
- GRASS SOCCER FIELD SHOWN ON THE DRAWINGS AS 180'-0" X 340'-0" (60 YARDS X 120 YARDS) IS FOR REFERENCE ONLY. ACTUAL SIZE OF EXISTING SOCCER FIELD MAY VARY.
- FOOTBALL FIELD SHOWN FOR REFERENCE AND SCALE ONLY ON THE EXISTING GRASS SOCCER FIELD. FOOTBALL FIELD AND STRIPING DOES NOT EXIST AND IS NOT PART OF THIS PROJECT.
- COORDINATE NEW TRACK SURFACE WITH EXISTING SURFACES TO REMAIN (CONCRETE AND ASPHALT). TRANSITIONS BETWEEN TRACK AND EXISTING SURFACES SHALL BE SMOOTH.
- COORDINATE NEW WORK WITH EXISTING FENCE.
- LOCATE, PROTECT, AND COORDINATE ALL WORK WITH EXISTING IRRIGATION SYSTEM TO REMAIN.
- LOCATE, PROTECT, AND COORDINATE ALL WORK WITH EXISTING IRRIGATION SYSTEM TO REMAIN.

Legend

- EXISTING BUILDING
- TRACK SURFACE (REMOVE EXISTING BASE)
- TRACK SURFACE (MILL EXISTING BASE)
- EXISTING CONCRETE SURFACE
- EXISTING GRAVEL SURFACE
- EXISTING FENCE
- EXISTING LIGHT POLE

Striping Notes

- COORDINATE ALL TRACK STRIPING, NUMBERING, SYMBOLS, INDICATIONS, ETC. WITH OWNER PRIOR TO INSTALLATION.

NOTE: THIS DRAWING IS INTENDED TO BE PLOTTED IN COLOR. IF THIS NOTE DOES NOT APPEAR IN COLOR, IT IS PLOTTED INCORRECTLY. DISCARD AND OBTAIN AN ACCURATE DRAWING

Notice

The Architect/Engineer does not define the scope of individual trades, subcontractors, material suppliers, or vendors. Any sheet numbering system used which identifies disciplines is solely for the Architect/Engineer's convenience, and is not intended to define a subcontractor's scope of work. Information regarding individual trades, subcontractors, material suppliers, and vendors may be detailed, described and indicated at different locations throughout these documents. No consideration will be given to requests for change orders for failure to obtain and review the complete set of drawings and specifications when preparing bids, prices, and quotations.



ISSUED FOR	DATE
Issue Date	Issue Date
Revisions	Issue Date
1	
2	
3	
4	
5	
6	
7	
8	

PROJECT TITLE
CHRISTIAN ACADEMY OF INDIANA
2025 TRACK AND FIELD IMPROVEMENTS
1000 ACADEMY DRIVE
NEW ALBANY, INDIANA 47150



OWNER
CHRISTIAN ACADEMY
SCHOOL SYSTEM

Drawn	BB
Checked By	BB

DATE
06/08/2025

SHEET NUMBER
C102
24-239-001

SHEET TITLE
Site Dimension Plan
...

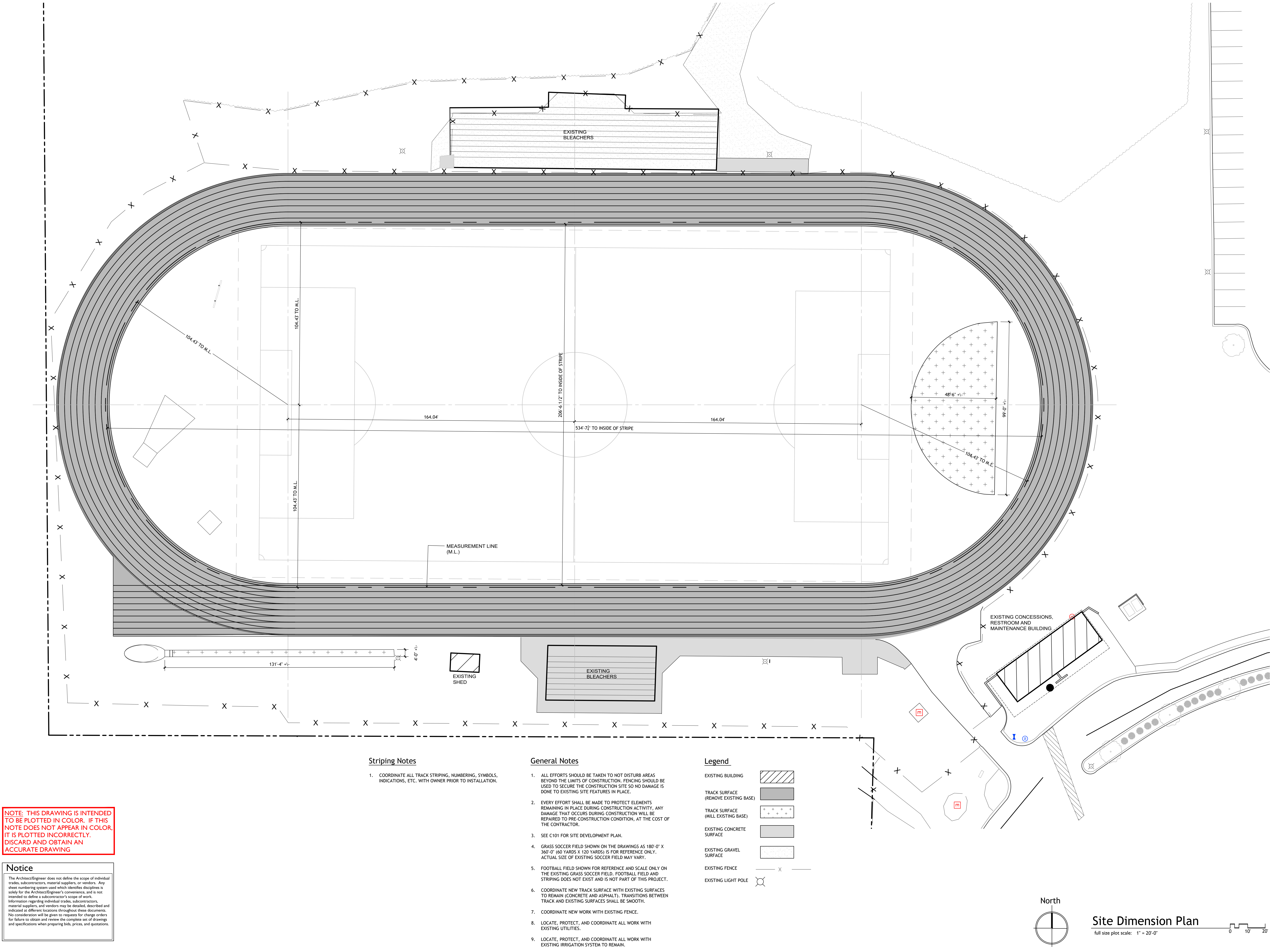

Striping Notes

1. COORDINATE ALL TRACK STRIPING, NUMBERING, SYMBOLS, INDICATIONS, ETC., WITH OWNER PRIOR TO INSTALLATION.

General Notes

1. ALL EFFORTS SHOULD BE TAKEN TO NOT DISTURB AREAS BEYOND THE LIMITS OF CONSTRUCTION. FENCING SHOULD BE USED TO SECURE THE CONSTRUCTION SITE SO NO DAMAGE IS DONE TO EXISTING SITE FEATURES IN PLACE.
2. EVERY EFFORT SHALL BE MADE TO PROTECT ELEMENTS REMAINING IN PLACE DURING CONSTRUCTION ACTIVITY. ANY DAMAGE THAT OCCURS DURING CONSTRUCTION WILL BE REPAIRED TO PRE-CONSTRUCTION CONDITION, AT THE COST OF THE CONTRACTOR.
3. SEE C101 FOR SITE DEVELOPMENT PLAN.
4. GRASS SOCCER FIELD SHOWN ON THE DRAWINGS AS 180'-0" X 360'-0" (60 YARDS X 120 YARDS) IS FOR REFERENCE ONLY. ACTUAL SIZE OF EXISTING SOCCER FIELD MAY VARY.
5. FOOTBALL FIELD SHOWN FOR REFERENCE AND SCALE ONLY ON THE EXISTING GRASS SOCCER FIELD. FOOTBALL FIELD AND STRIPING DOES NOT EXIST AND IS NOT PART OF THIS PROJECT.
6. COORDINATE NEW TRACK SURFACE WITH EXISTING SURFACES TO REMAIN (CONCRETE AND ASPHALT). TRANSITIONS BETWEEN TRACK AND EXISTING SURFACES SHALL BE SMOOTH.
7. COORDINATE NEW WORK WITH EXISTING FENCE.
8. LOCATE, PROTECT, AND COORDINATE ALL WORK WITH EXISTING UTILITIES.
9. LOCATE, PROTECT, AND COORDINATE ALL WORK WITH EXISTING IRRIGATION SYSTEM TO REMAIN.

Legend

EXISTING BUILDING	
TRACK SURFACE (REMOVE EXISTING BASE)	
TRACK SURFACE (WILL EXISTING BASE)	
EXISTING CONCRETE SURFACE	
EXISTING GRAVEL SURFACE	
EXISTING FENCE	
EXISTING LIGHT POLE	

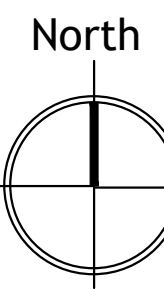

Site Dimension Plan

full size plot scale: 1" = 20'-0"

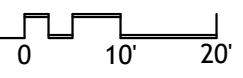

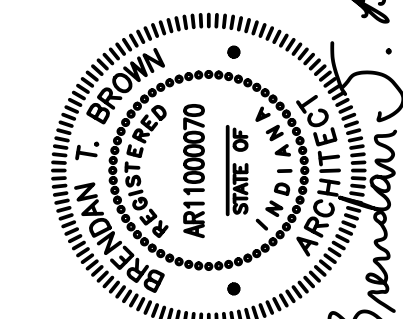

ISSUED FOR	DATE
Issue Date	Issue Date
Revisions	Issue Date
1	
2	
3	
4	
5	
6	
7	
8	

PROJECT TITLE
CHRISTIAN ACADEMY OF INDIANA
2025 TRACK AND FIELD IMPROVEMENTS
1000 ACADEMY DRIVE
NEW ALBANY, INDIANA 47150



OWNER
CHRISTIAN ACADEMY
SCHOOL SYSTEM

Drawn	BB/DB
Checked By	BB

DATE
06/08/2025

SHEET NUMBER
C201
24-239-001

SHEET TITLE
STORM DRAINAGE PLAN

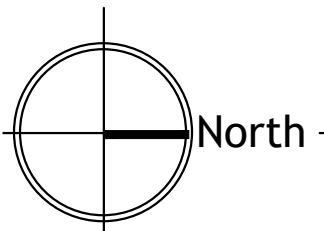

Storm Drainage Plan
full size plot scale: 1" = 20'-0"

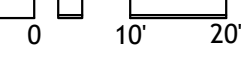

PUBLIC UTILITY EASEMENT
INST. 200501140

PUBLIC UTILITY EASEMENT
INST.

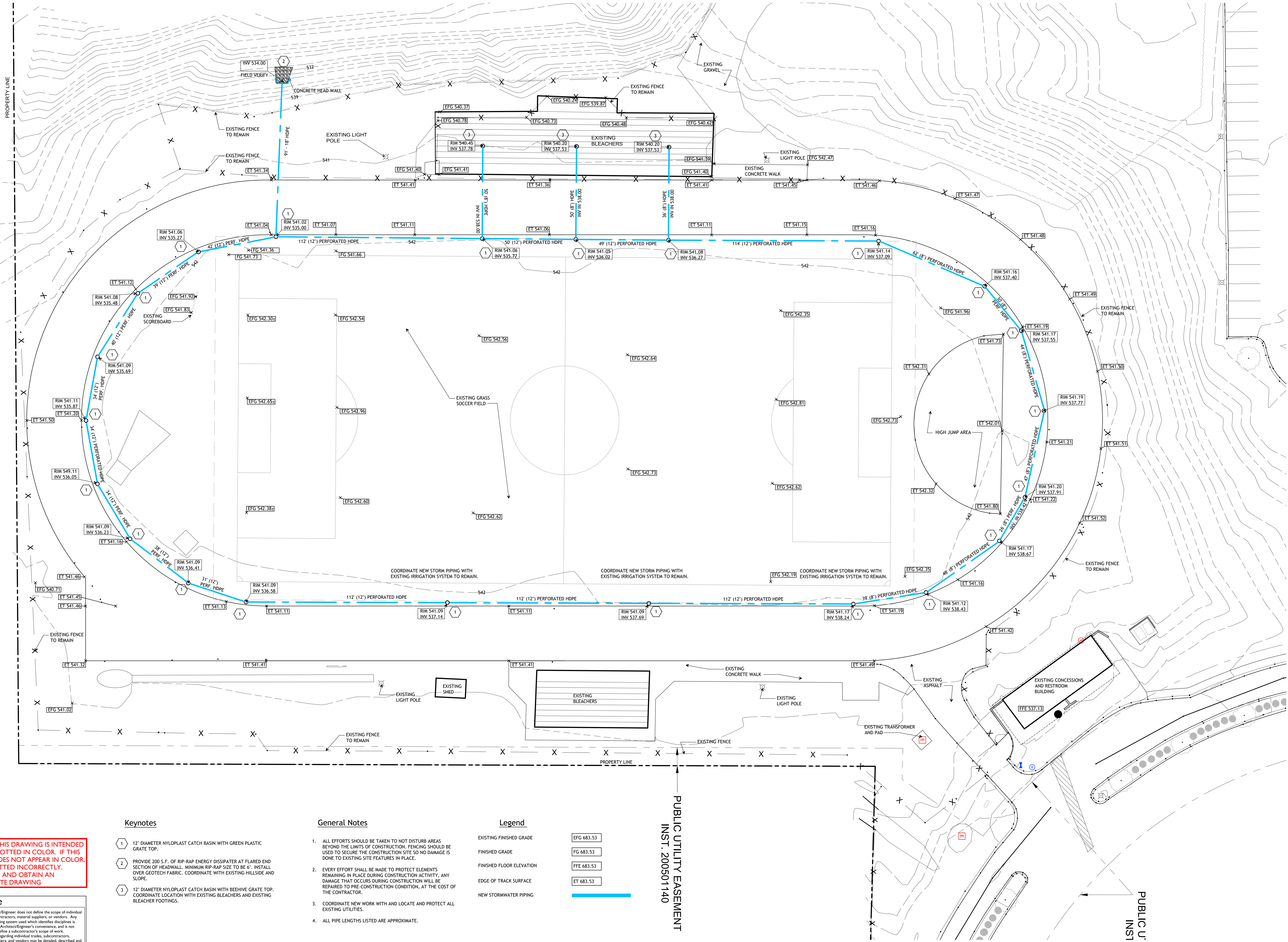

Keynotes

- 12" DIAMETER NYLOPLAST CATCH BASIN WITH GREEN PLASTIC GRATE TOP.
- PROVIDE 200 S.F. OF RIP-RAP ENERGY DISSIPATER AT FLARED END SECTION OF HEADWALL. MINIMUM RIP-RAP SIZE TO BE 6". INSTALL OVER GEOTEC FABRIC. COORDINATE WITH EXISTING HILLSIDE AND SLOPE.
- 12" DIAMETER NYLOPLAST CATCH BASIN WITH BEEHIVE GRATE TOP. COORDINATE LOCATION WITH EXISTING BLEACHERS AND EXISTING BLEACHER FOOTINGS.

General Notes

- ALL EFFORTS SHOULD BE TAKEN TO NOT DISTURB AREAS BEYOND THE LIMITS OF CONSTRUCTION. FENCING SHOULD BE USED TO SECURE THE CONSTRUCTION SITE SO NO DAMAGE IS DONE TO EXISTING SITE FEATURES IN PLACE.
- EVERY EFFORT SHALL BE MADE TO PROTECT ELEMENTS REMAINING IN PLACE DURING CONSTRUCTION ACTIVITY. ANY DAMAGE THAT OCCURS DURING CONSTRUCTION WILL BE REPAIRED TO PRE-CONSTRUCTION CONDITION, AT THE COST OF THE CONTRACTOR.
- COORDINATE NEW WORK WITH AND LOCATE AND PROTECT ALL EXISTING UTILITIES.
- ALL PIPE LENGTHS LISTED ARE APPROXIMATE.

Legend

- | | |
|--------------------------|------------|
| EXISTING FINISHED GRADE | EFG 683.53 |
| FINISHED GRADE | FG 683.53 |
| FINISHED FLOOR ELEVATION | FFE 683.53 |
| EDGE OF TRACK SURFACE | ET 683.53 |
| NEW STORMWATER PIPING | |

NOTE: THIS DRAWING IS INTENDED TO BE PLOTTED IN COLOR. IF THIS NOTE DOES NOT APPEAR IN COLOR, IT IS PLOTTED INCORRECTLY. DISCARD AND OBTAIN AN ACCURATE DRAWING

Notice
The Architect/Engineer does not define the scope of individual trades, subcontractors, material suppliers, or vendors. Any sheet numbering system used which identifies disciplines is solely for the Architect/Engineer's convenience, and is not intended to define a subcontractor's scope of work. Information regarding individual trades, subcontractors, material suppliers, and vendors may be detailed, described and indicated at different locations throughout these documents. No consideration will be given to requests for change orders for failure to obtain and review the complete set of drawings and specifications when preparing bids, prices, and quotations.

NOTE: THIS DRAWING IS INTENDED TO BE PLOTTED IN COLOR. IF THIS NOTE DOES NOT APPEAR IN COLOR, IT IS PLOTTED INCORRECTLY. DISCARD AND OBTAIN AN ACCURATE DRAWING

Notice

The Architect/Engineer does not define the scope of individual trades, subcontractors, material suppliers, or vendors. Any sheet numbering system used which identifies disciplines is solely for the Architect/Engineer's convenience, and is not intended to define a subcontractor's scope of work. Information regarding individual trades, subcontractors, material suppliers, and vendors may be detailed, described and indicated at different locations throughout these documents. No consideration will be given to requests for change orders for failure to obtain and review the complete set of drawings and specifications when preparing bids, prices, and quotations.

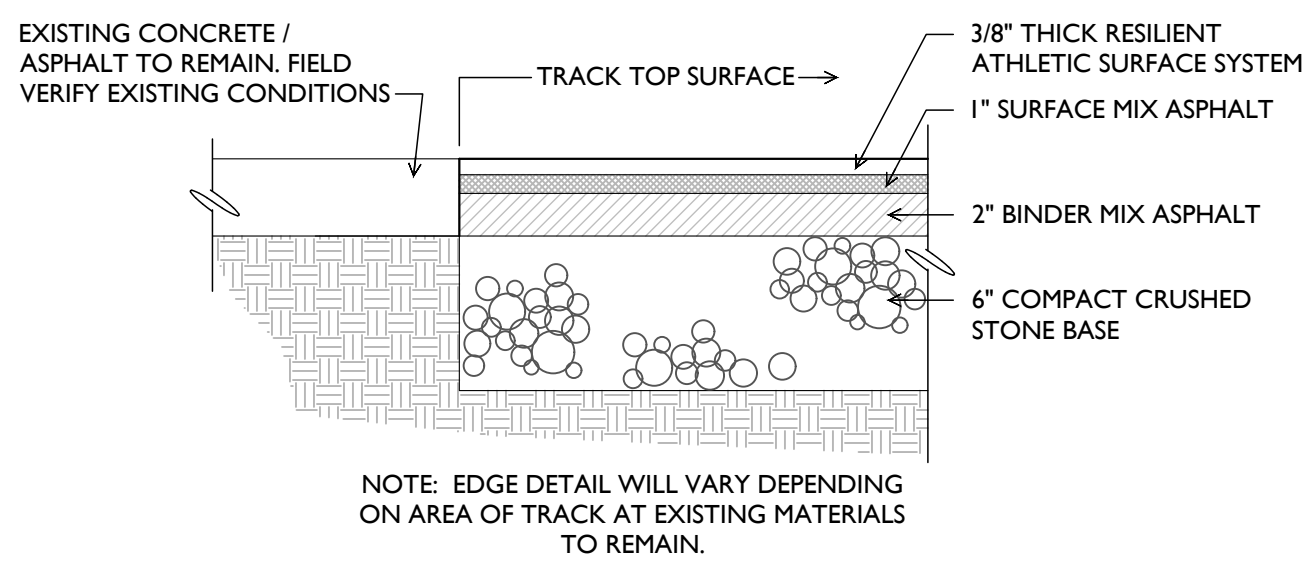

5 Track Edge Treatment @ Existing Pavement
C-301 NOT TO SCALE

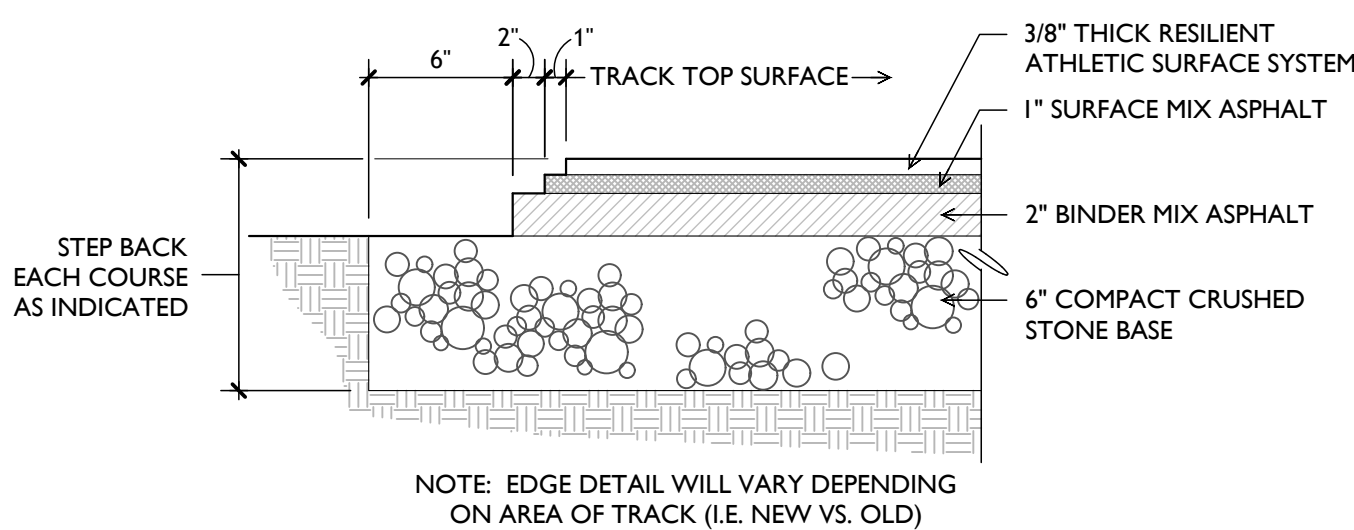

4 Track Edge Treatment @ Grass Areas
C-301 NOT TO SCALE

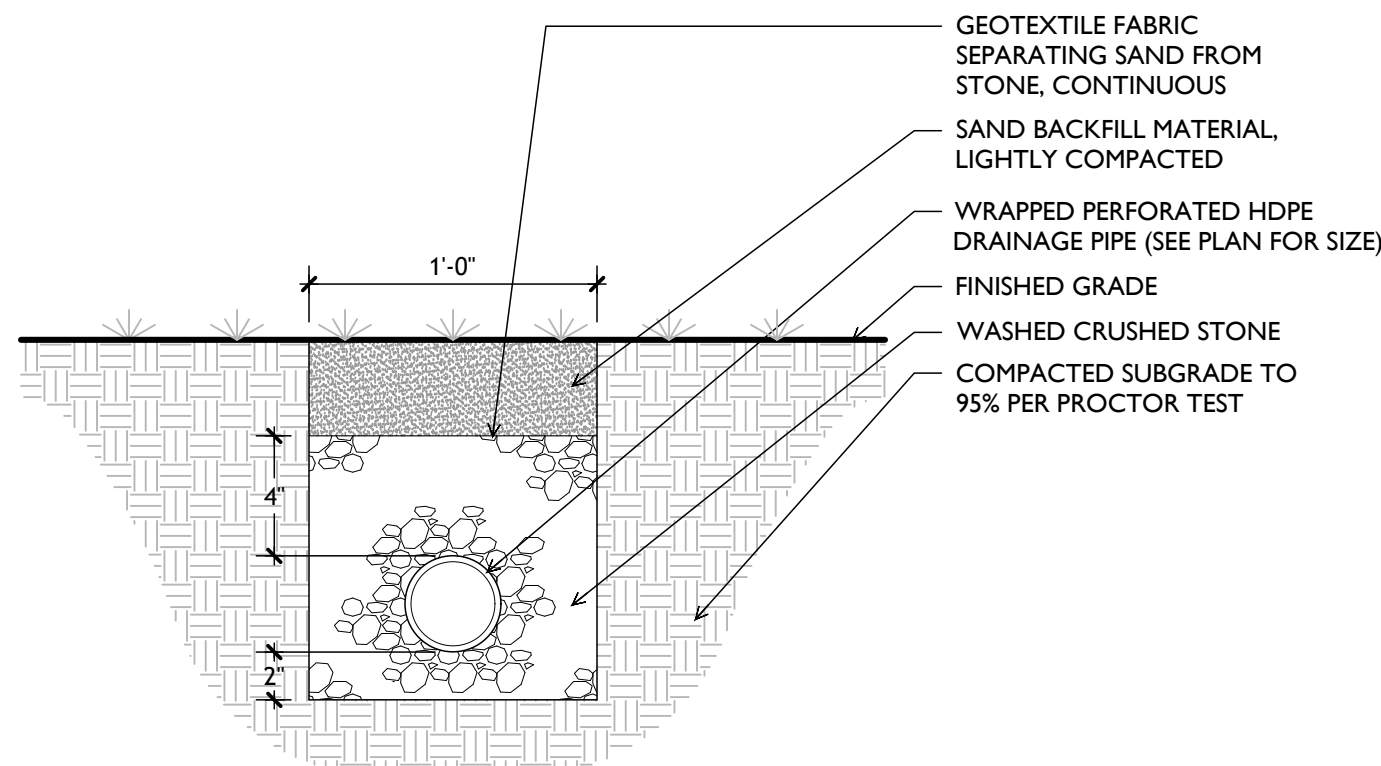

8 Perforated Pipe Bedding Detail
C-301 NOT TO SCALE

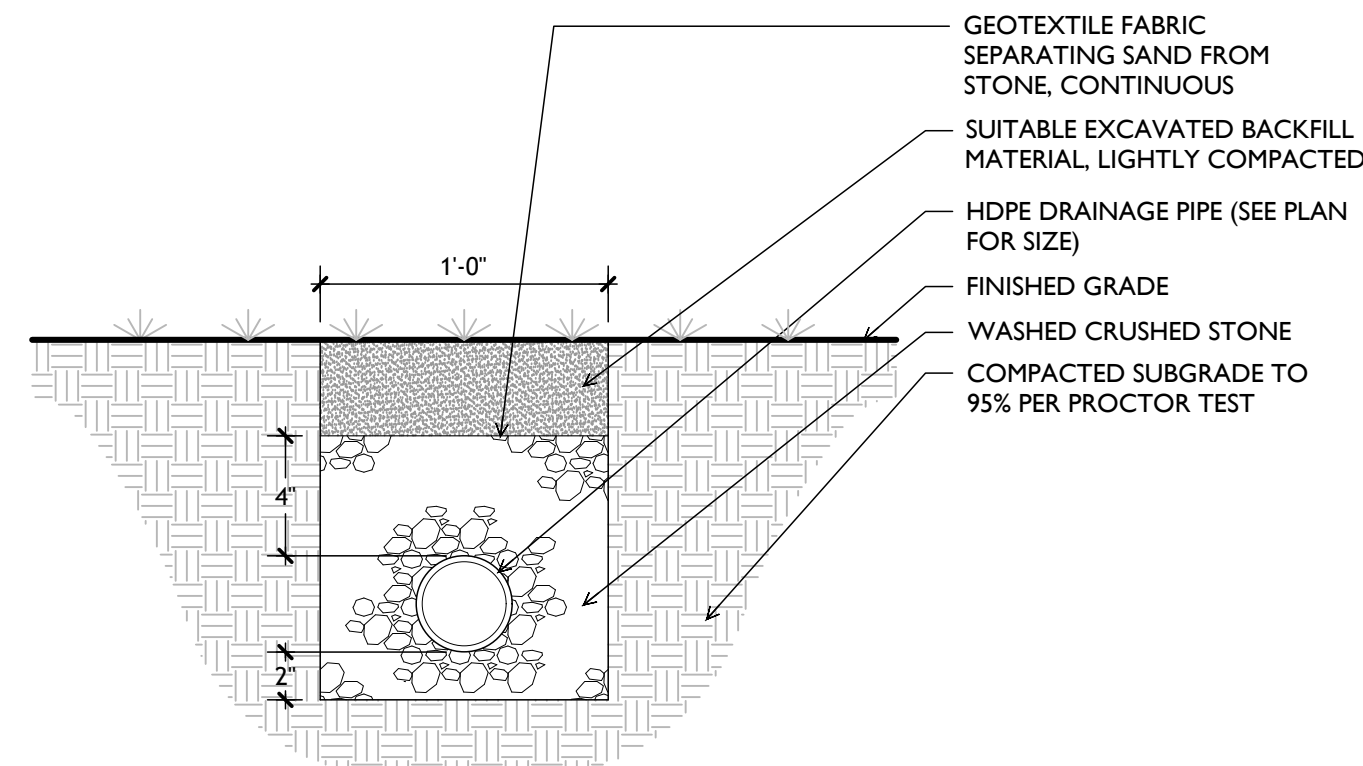

7 Solid Pipe Bedding Detail
C-301 NOT TO SCALE

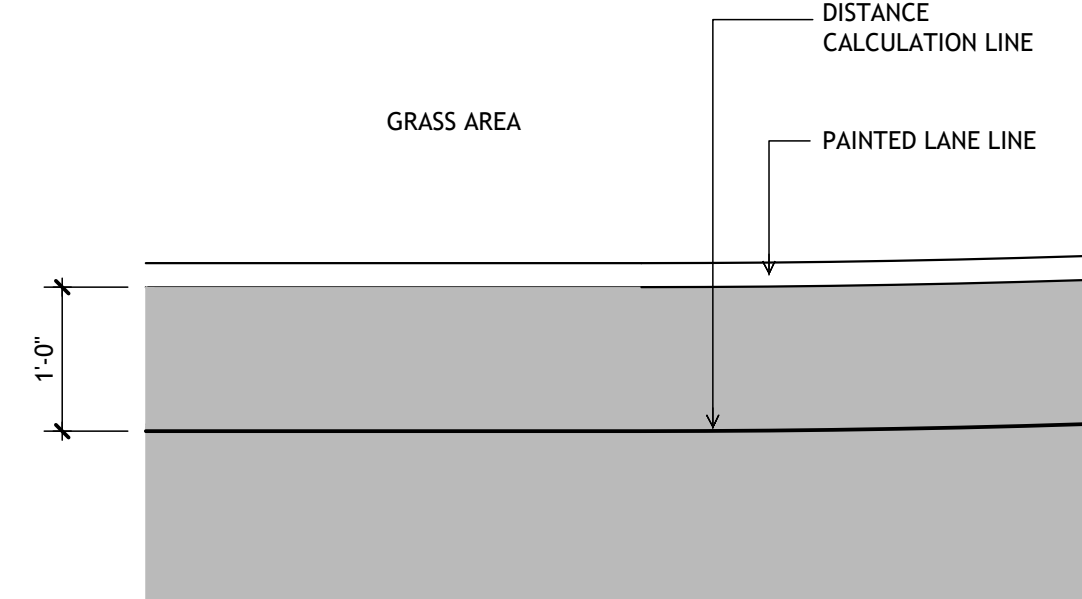

6 Lane Stripe at Inside
C-301 NOT TO SCALE

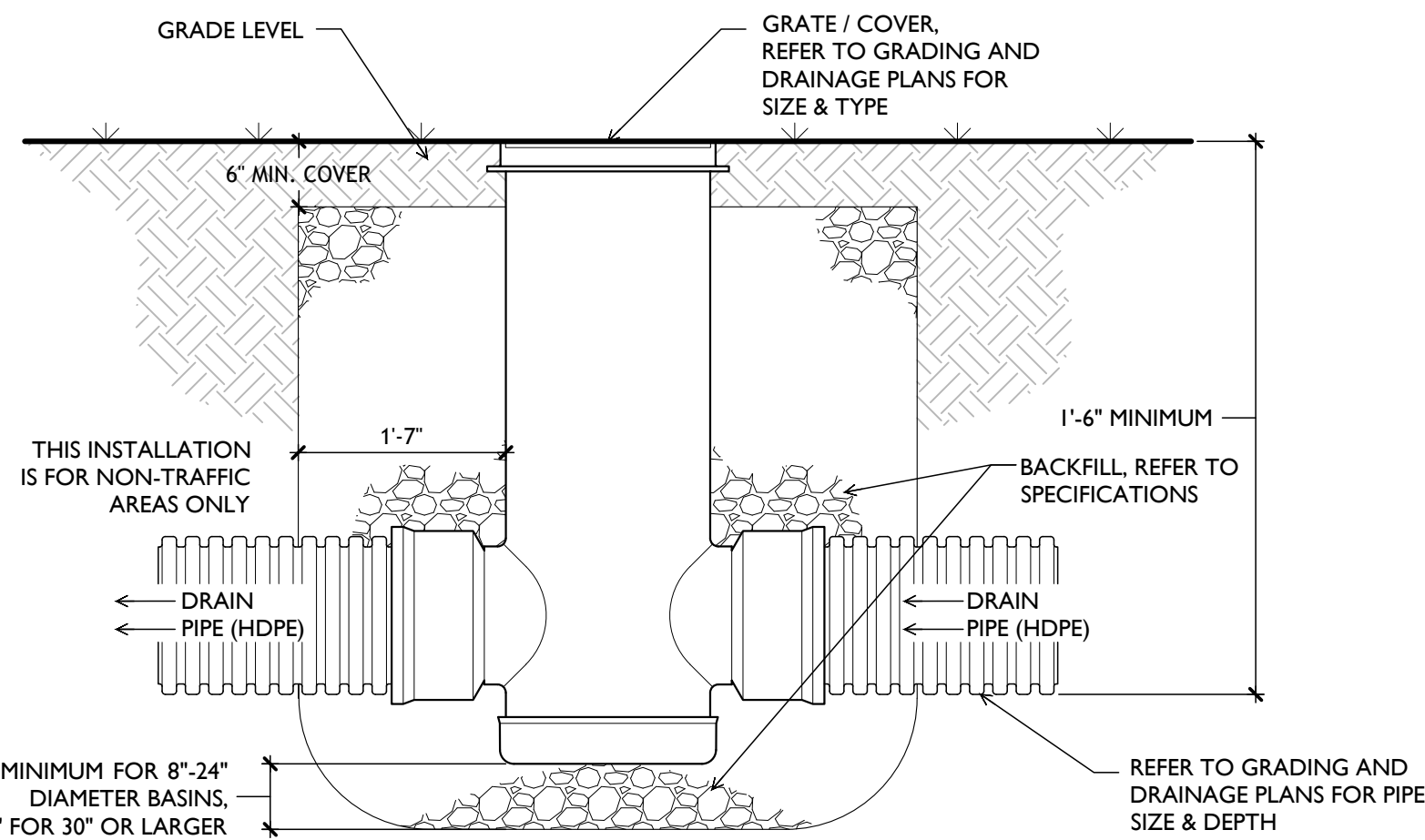

10 Typical Nyoplast Drain Basin Detail
C-301 NOT TO SCALE

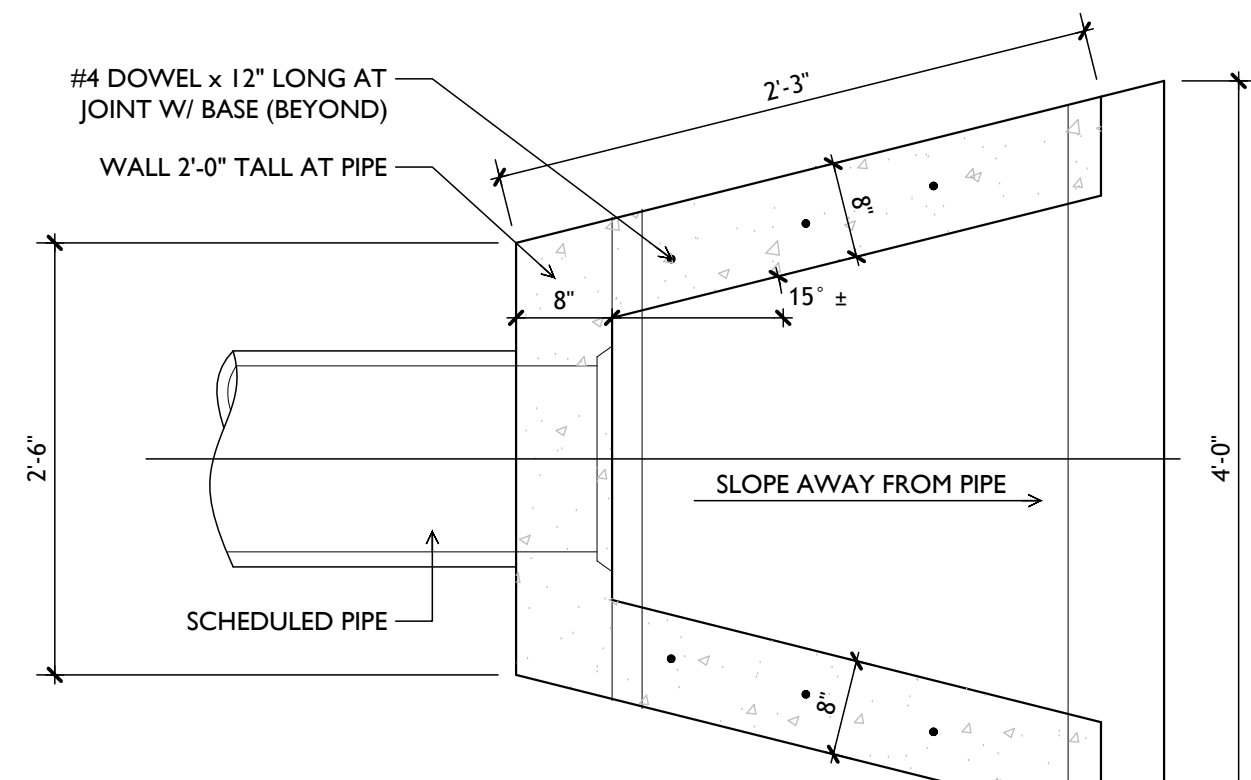

NOTES:
1. HEADWALL SHALL MEET OR EXCEED THE INDIANA DEPARTMENT OF HIGHWAYS APPLICABLE STANDARD DETAIL OF SLOPED AND FLARED HEADWALLS FOR PIPE.
2. REINFORCING STEEL TO BE MINIMUM GRADE 60, EVENLY SPACED.
3. DIMENSIONS AND QUANTITIES ARE APPROXIMATE, BASED UPON CONCRETE PIPE; ADJUST AS REQUIRED.

9 Concrete Headwall
C-301 NOT TO SCALE

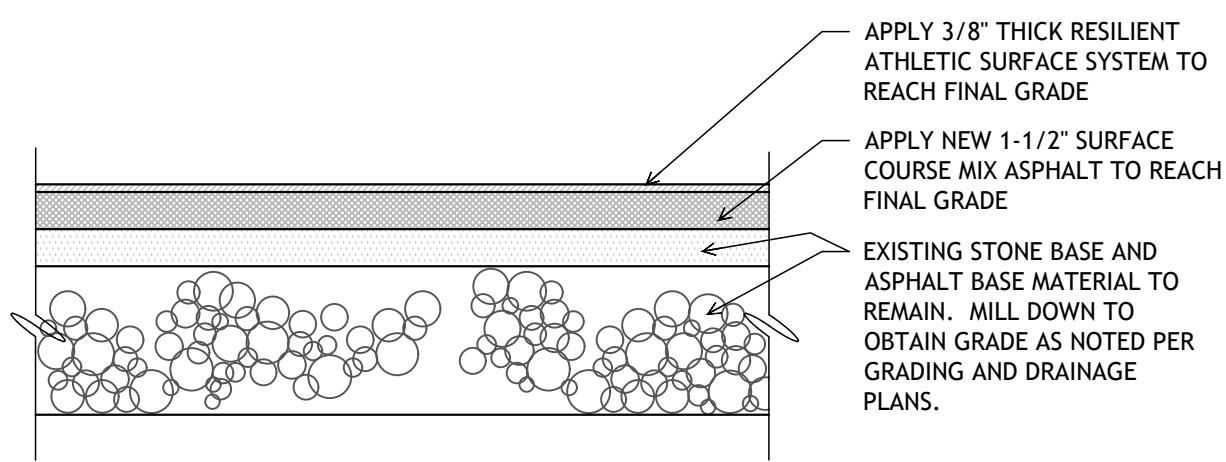

2 Track Surface 2 Paving Section
C-301 NOT TO SCALE

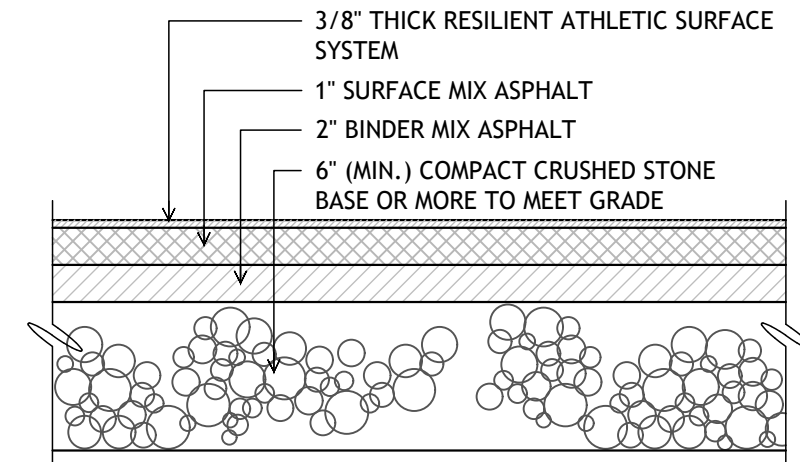

1 Track Surface 1 Paving Section
C-301 NOT TO SCALE

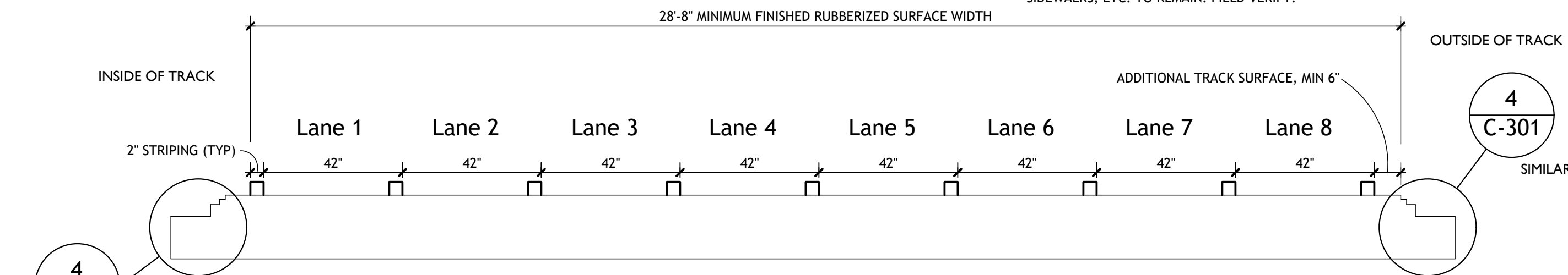

3 New Track Striping Section
C-301 NOT TO SCALE

ISSUED FOR	DATE
Bidding Only	Issue Date
>>	date
Revisions	
1	
2	
3	
4	
5	
6	
7	
8	



Drawn	CE / BB
Checked By	BB