



ADDENDUM No. 3

Project: First Floor - Clinic Renovations
Clark County Health Department

Jeffersonville, Indiana

Proj. No: 1901.01

Date: March 18, 2019

This addendum is a part of the bid documents. Acknowledge receipt on the Proposal Form.

General

1. Notify Brendan Brown of any questions regarding bidding at phone (812-913-4615) or email (Brendan.brown@koverthawkins.com).

Specifications

Section 03 54 00 (Self-leveling Concrete Floor Underlayment)

Add this section in its entirety.

Drawings

A-001

- Add Drawing AD-3a for additional floor prep.

I-102

- Specialty 19: Replace "Casework" with "Countertop".

Prepared by,

Brendan J. Brown

Brendan T. Brown, AIA
Project Manager

enclosed: AD-3a, Spec 03 54 00

file: 1901.01

End of Addendum No. 3 (4 total pages)



SECTION 03 54 00 - SELF-LEVELING CONCRETE FLOOR UNDERLAYMENT

PART 1 - GENERAL

1.01 WORK INCLUDED

- A. Furnish labor, material, equipment, special tools, supervision, and services required to prep substrate and properly place self-leveling concrete floor underlayment as indicated on drawings and specified herein.

1.02 QUALITY ASSURANCE

- A. Installer's Qualifications: Installation of underlayment shall be by an applicator authorized by the manufacturer using manufacturer's approved mixing and pumping equipment.

1.03 DELIVERY, STORAGE AND HANDLING

- A. General Requirements: Materials shall be delivered in their original, unopened packages, and protected from exposure to the elements. Damaged or deteriorated materials shall be removed from the premises.

1.04 SITE CONDITIONS

- A. Environmental Requirements: Before, during and after installation of underlayment, building interior shall be enclosed and maintained at a temperature above 50 degrees F (10 degrees C) and below 100 degrees F (37.7 degrees C) until structure and subfloor temperature are stabilized.

PART 2 - PRODUCTS

2.01 MATERIALS

- A. Cementitious Self-Leveling Poured Floor Underlayment: Floor underlayment compound to be Level-Right Self-Leveling Floor Underlayment as manufactured by Maxxon Corporation or approved equivalent.
- B. Sand Aggregate: Sand shall be silica aggregate meeting requirements of manufacturer.
- C. Mix Water: Potable, free from impurities.
- D. Subfloor Primer: Underlayment manufacturer's recommended primer as required.
- E. Sealer: Underlayment manufacturer's recommended sealer as required.

2.02 MIX DESIGNS

- A. General Requirements: Underlayment mix proportions and methods shall be in strict accordance with product manufacturer recommendations.

PART 3 - EXECUTION

3.01 PREPARATION

- A. Condition and Cleaning of Subfloor: Subfloor shall be structurally sound. Contractor shall clean subfloor to remove mud, oil, grease, and other contaminating factors.
- B. Leak Prevention: Fill cracks and voids with a quick setting patching or caulking material where leakage of underlayment could occur.

C. Priming Subfloor: Prime concrete subfloor using the manufacturer's recommended primer. Priming instructions vary according to the porosity of the concrete, multiple coats may be necessary.

D. Expansion Joints: Allow joints to continue through the underlayment at the same width.

3.02 APPLICATION OF SELF-LEVELING UNDERLAYMENT

A. Scheduling: Application of underlayment shall not begin until the building is enclosed, including roof, windows, doors, and other fenestration.

B. Application: Place underlayment from 3" (76 mm) to featheredge. Spread and float to a smooth surface. Except at authorized joints, place underlayment as continuously as possible until application is complete so that no slurry is placed against underlayment that has obtained its initial set.

C. Drying: Contractor shall provide continuous ventilation and adequate heat while curing.

3.03 PREPARATION FOR INSTALLATION OF FLOORING

A. Sealing:

1. Seal all areas according to manufacturer's recommendations.
2. Verify sealer compatibility with flooring adhesives prior to installation.

B. Refer to manufacturer's guidelines for additional information regarding flooring installation.

3.04 FIELD QUALITY CONTROL

A. Slump Test: Underlayment mix shall be tested for slump as it is being pumped using a 2 inch by 4 inch (50 mm by 101 mm) cylinder resulting in a patty size of 9 1/2 inches (241 mm) plus or minus 1 inch (25 mm) diameter.

B. Field Samples: At least one set of 3 molded cube samples shall be taken from each day's pour during the underlayment application. Cubes shall be tested as recommended by the manufacturer in accordance with modified ASTM C 109. Test results shall be available to architect and/or contractor upon request from applicator.

3.05 PROTECTION

A. Protection From Heavy Loads: During construction, place temporary wood planking over underlayment wherever it will be subject to heavy wheeled or concentrated loads.

END OF SECTION 03 54 00

630 Walnut Street
Jeffersonville, IN 47130
812. 282. 9554
812. 282. 9171 FAX
www.koverthawkins.com



KovertHawkins
architects

Drawn	AH
Checked By	HK
Project No.	1901.01
Date	03/18/2019
Revisions	1
2	
3	
4	
5	
6	
Certified By	

First Floor - Clinic Renovations
Clark County Health Dept.
Jeffersonville, Indiana 47130
1201 Wall St.

Sheet

AD-3a

EAST BREAK ROOM

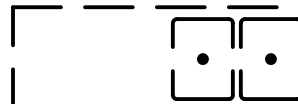

EAST SERVICE ROOM

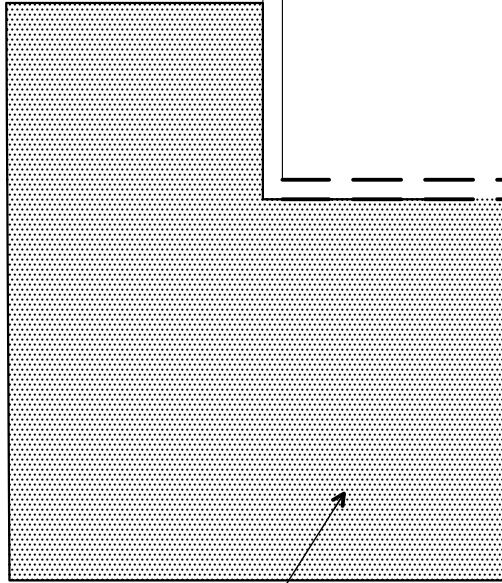
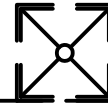

AREA OF SELF-LEVELING CONCRETE
FLOOR UNDERLAYMENT
(SPECIFICATION SECTION 03 54 00)

